

CATALOG  
C24

# EMI<sup>®</sup>

CONVEYORS &  
AUTOMATION SYSTEMS



## Trim Line ATLC Aluminum Frame | Cleated Belt

**Standard belt widths: 4", 6", 9", 12", 18", 24"**  
**Standard lengths: 3'–20' at 1' increments**

Trim Line incline, cleated-belt conveyors are perfect for many uses including moving parts away from the press to a trunkline, box filling system or work station. Adjustable leg sets make height and angle adjustments simple. A wide choice of options allow Trim Line conveyors to be customized to suit many different types of applications. Standard units are rated for a 50 lb. maximum load capacity.



*Click for 360° View!*

### Features

- Direct Drive ¼ hp 110V input AC variable-speed drive package.
- No roller chain or sprockets.
- Sealed gear reducer.
- 50 lb. maximum load.
- ⅛" anodized aluminum construction.
- Double V-guided, FDA approved, white PVC belt with 1½" tall cleats on 18" centers.
- 2" tall side rails, lapped over conveyor belt.
- Leg sets and swivel castors included.
- Hopper not included (H-8 hopper shown).
- 15' power cord included. Pre-wired ready to run (except polyphase systems which require some customer wiring).
- Control wiring contained in liquid-tight conduit and connectors.
- Units up to 10' length ship fully assembled.
- 3-Year Limited Warranty, see page 3.

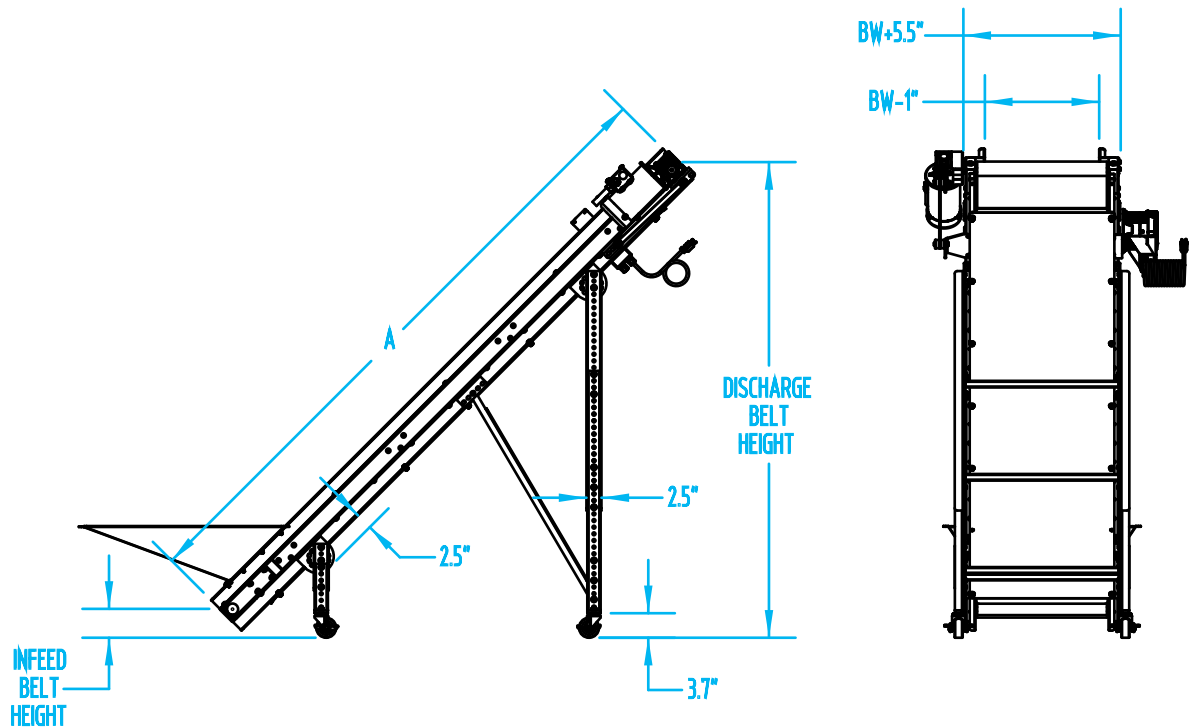
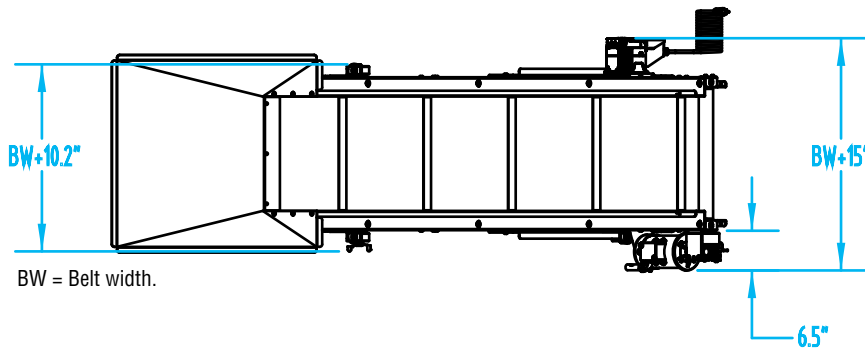

**How to Order:**

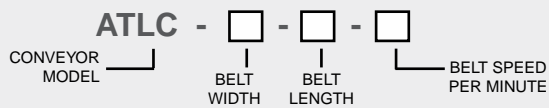

Specify the conveyor Infeed and Discharge Belt Height. Leg set #1 will be located under drive package for 3'-6' long and 6"-9" wide conveyors. Download Conveyor Specifications Form [here](#).

**Common Options**

- Infeed hoppers, see page 175 for sizes and dimensions.
- Alternate conveyor speeds.
- Alternate cleat spacing.
- Polycarbonate rail covers.
- Angled nose over.
- Stainless steel discharge chute.
- Robotic and box filling control systems.
- Weigh scale.
- Alternate motor locations, see page 177.
- Numerous belt options, see page 106.