

CATALOG
C24

EMI[®]

CONVEYORS &
AUTOMATION SYSTEMS



SL-18 Pin Style Part / Runner Separator

Flat-Belt Separators: Available on Models: ADF, DDF, EAF, RM & CLR with 12" and 18" belt width.

A versatile part/runner separator normally positioned at the end of an under press conveyor. The unit incorporates interchangeable pins (pull out and reposition to achieve the best separation rate), a double "True-Track" belt guidance system, an enclosed protected drive, and a stainless steel infeed chute. This part/runner separator is available (as an option) for conveyor attachment.

Features

- 18" Belt Width.
- 40 FPM Belt speed standard.
- Heavy-duty "Industrial Use" construction.
- Interchangeable 2¾" long pins, available in shorter lengths as required.
- Pins are available blunt or tapered. Both styles are available in HDPE. Tapered pins are also available in nylon.
- 16-gauge stainless steel adjustable position infeed chute.
- Double True-Track belt guidance system.
- 12-gauge adjustable height support stand.
- EMI Separators are shipped completely assembled, simply position the legs and they're ready to run.
- 3-Year Limited Warranty, see page 3.



Common Options

- 60 FPM constant belt speed.
- 0–100 FPM variable belt speed.
- Spare pin belts.
- Extended separator head, in 12" increments.
- Alternate pin styles & materials.

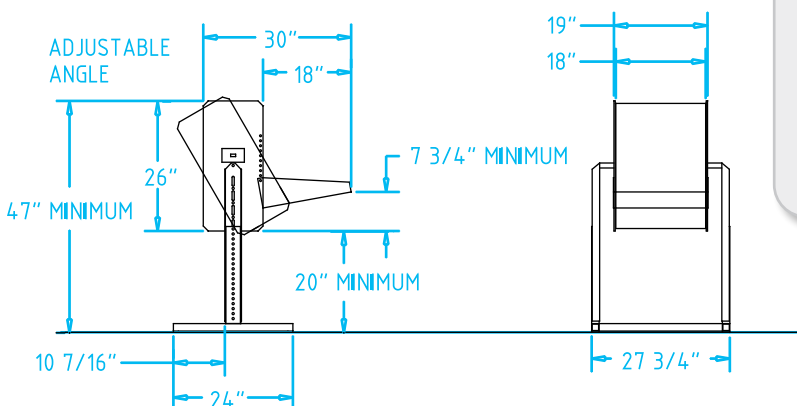

How to Order:

Specify one of the following options for your belt conveyor/separator combination:

- Option F-1, 60 FPM Constant Belt Speed
- Option F-2, 40 FPM Constant Belt Speed
- Option F-3, 0-100 FPM Variable Belt Speed
- Option F-6, Extended length separator head, in 12" increments. Specify desired extension length.

SL-18 Pin Style Part / Runner Separator

Stand-Alone



Features:

- Deionizing bar
- Containment hood
- EA-PLC Controller for bad shot reversing
- Polycarbonate covers and extension rails

Connected to a Flat Belt Conveyor



Part-Runner Separation Evaluation:

What we need:

- 1. Sample Parts and Runners**
 Send us three complete "shots". Be sure the runners are typical of the runners that the separator must work on. If you run a fast cycle and the runners "curl up", send us those runners.
- 2. The Cycle Time**
 In seconds.
- 3. Conveyor Style**
 Your preference of conveyor style, such as flat belt or cleated belt.
- 4. Press Dimensions**
 Fill out the appropriate press dimensional data form, located on pages 178-179.

Send samples to: EMI Corp. 28300 Euclid Ave, Wickliffe OH 44092 (Be sure to include your name, phone and company name.)